

| INVENTORY PARTS LIST* | | | |
|-----------------------|------------------------------------|---|---------------------------------|
| A | UPPER, RIGHT-HAND PERFORATED FRAME | H | LOWER REAR BAFFLE |
| B | LOWER, LEFT-HAND PERFORATED FRAME | I | VERTICAL MOUNTING FLANGE BAFFLE |
| C | UPPER, LEFT-HAND PERFORATED FRAME | J | LOWER VERTICAL BAFFLE |
| D | LOWER, RIGHT-HAND PERFORATED FRAME | K | UPPER VERTICAL BAFFLE |
| E | SIDE BRACE | L | LEFT-HAND TOP COVER |
| F | BOTTOM COVER | M | RIGHT-HAND TOP COVER |
| G | LOWER EXHAUST BAFFLE | N | HORIZONTAL BAFFLE ASSEMBLY |

* INVENTORY PARTS LIST REFERANCES PARTS ON SHEETS 1 AND 2.

NOTES:

1. INSTALLATION MUST COMPLY WITH ALL APPLICABLE NATIONAL AND LOCAL CODES.
2. PLEASE REFER TO APC PRODUCT MANUAL FOR DETAILS.
3. NET WEIGHT IS 114.64 LBS. [52.00 KG].

THIS DRAWING AND SPECIFICATIONS HEREIN ARE THE PROPERTY OF SCHNEIDER ELECTRIC AND SHALL NOT BE COPIED, REPRODUCED OR USED IN WHOLE OR IN PART, AS THE BASIS FOR THE MANUFACTURE OR SALE OF ITEMS WITHOUT WRITTEN PERMISSION FROM SCHNEIDER ELECTRIC. THIS DRAWING IS BASED UPON LATEST AVAILABLE INFORMATION AND IS SUBJECT TO CHANGE WITHOUT NOTICE.



TITLE: NETSHELTER SX 42U
NEXUS 7018 DUCT KIT
EXTERNAL BAFFLE ASSEMBLY
ISOMETRIC VIEW

PROJECT: STD SUBMITTAL DRAWINGS SHEET 1 OF 5

| | | | | |
|-----------|-----------------|-----------|--------------|-------------|
| DWG NO: | AR7742 | | REV. | 0 |
| DRAWN BY: | S CUNHA | 01-AUG-11 | THIRD | ANGLE |
| ENGINEER: | Y WANG/J KUMMER | 01-AUG-11 | APPROVED BY: | T HORSTMANN |
| | | 01-AUG-11 | | PROJ. |

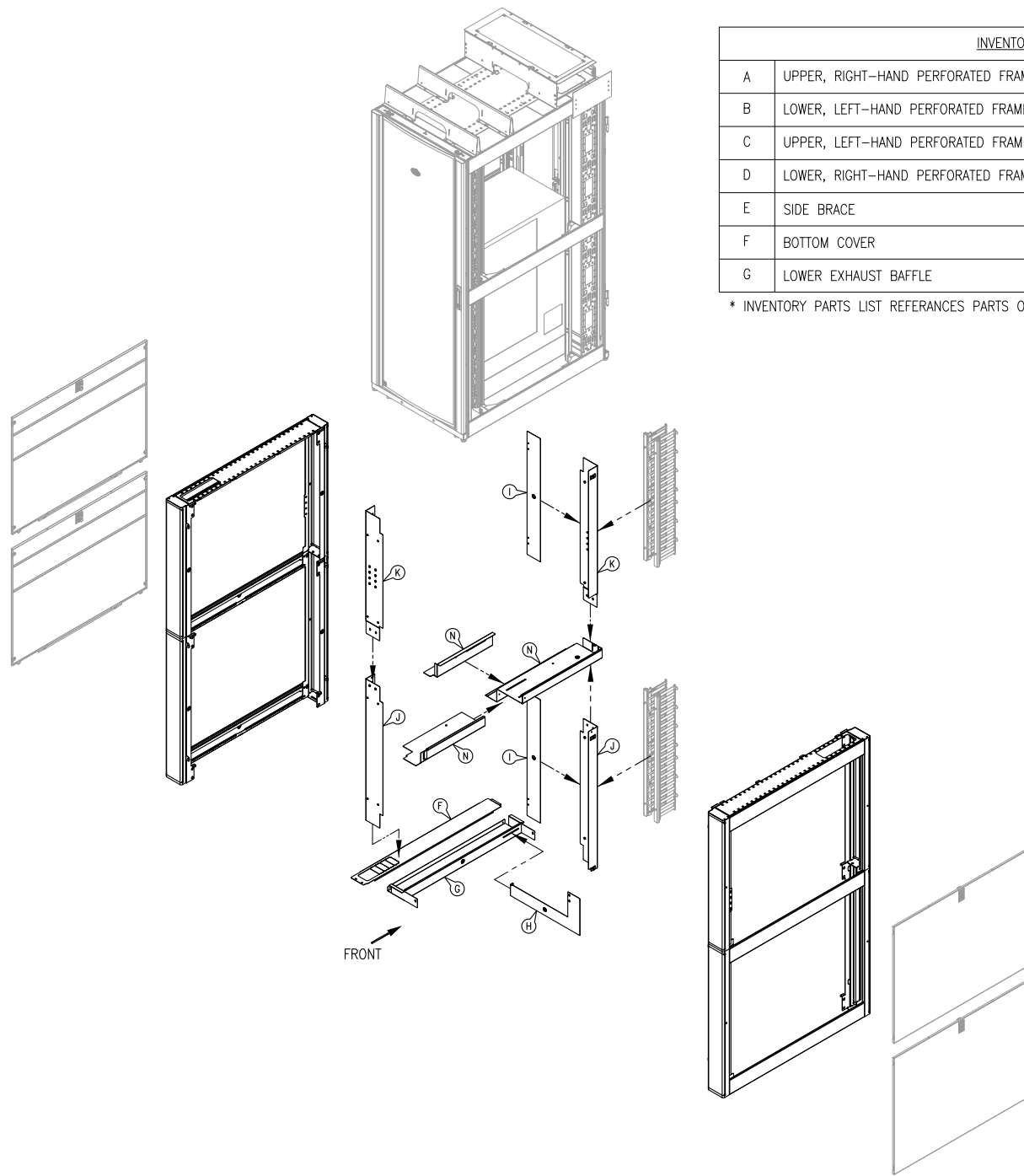

| INVENTORY PARTS LIST* | | | |
|-----------------------|------------------------------------|---|---------------------------------|
| A | UPPER, RIGHT-HAND PERFORATED FRAME | H | LOWER REAR BAFFLE |
| B | LOWER, LEFT-HAND PERFORATED FRAME | I | VERTICAL MOUNTING FLANGE BAFFLE |
| C | UPPER, LEFT-HAND PERFORATED FRAME | J | LOWER VERTICAL BAFFLE |
| D | LOWER, RIGHT-HAND PERFORATED FRAME | K | UPPER VERTICAL BAFFLE |
| E | SIDE BRACE | L | LEFT-HAND TOP COVER |
| F | BOTTOM COVER | M | RIGHT-HAND TOP COVER |
| G | LOWER EXHAUST BAFFLE | N | HORIZONTAL BAFFLE ASSEMBLY |

* INVENTORY PARTS LIST REFERANCES PARTS ON SHEETS 1 AND 2.

NOTES:

1. INSTALLATION MUST COMPLY WITH ALL APPLICABLE NATIONAL AND LOCAL CODES.
2. PLEASE REFER TO APC PRODUCT MANUAL FOR DETAILS.

THIS DRAWING AND SPECIFICATIONS HEREIN ARE THE PROPERTY OF SCHNEIDER ELECTRIC AND SHALL NOT BE COPIED, REPRODUCED OR USED IN WHOLE OR IN PART, AS THE BASIS FOR THE MANUFACTURE OR SALE OF ITEMS WITHOUT WRITTEN PERMISSION FROM SCHNEIDER ELECTRIC. THIS DRAWING IS BASED UPON LATEST AVAILABLE INFORMATION AND IS SUBJECT TO CHANGE WITHOUT NOTICE.



TITLE: NETSHELTER SX 42U
NEXUS 7018 DUCT KIT
INTERNAL BAFFLE ASSEMBLY
ISOMETRIC VIEW

PROJECT: STD SUBMITTAL DRAWINGS SHEET 2 OF 5

| | | | | |
|-----------|-----------------|-----------|--------------|-------------|
| DWG NO: | AR7742 | | REV: | 0 |
| DRAWN BY: | S CUNHA | 01-AUG-11 | THIRD | ANGLE |
| ENGINEER: | Y WANG/J KUMMER | 01-AUG-11 | APPROVED BY: | T HORSTMANN |
| | | 01-AUG-11 | | PROJ. |

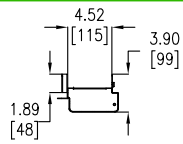

PART "A" – TOP VIEW

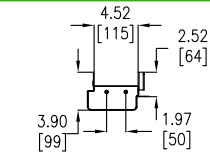

PART "B" – TOP VIEW

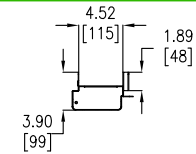

PART "C" – TOP VIEW

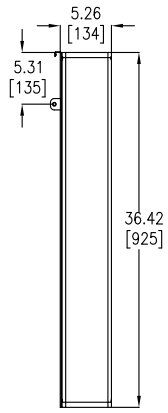

PART "A" – FRONT VIEW

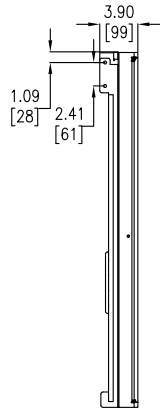

PART "A" – SIDE VIEW

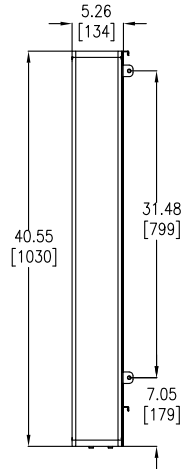

PART "B" – FRONT VIEW

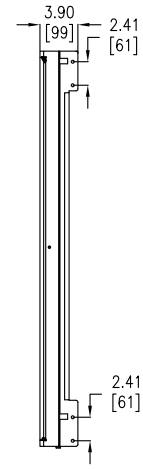

PART "B" – SIDE VIEW

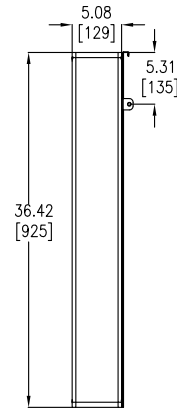

PART "C" – FRONT VIEW

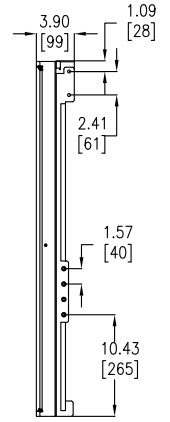

PART "C" – SIDE VIEW

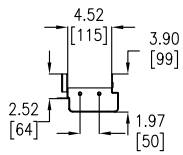

PART "D" – TOP VIEW

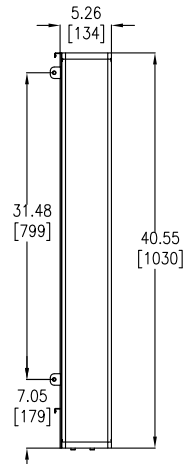

PART "D" – FRONT VIEW

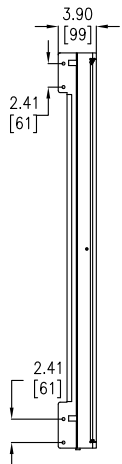

PART "D" – SIDE VIEW

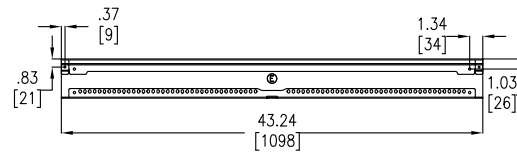

PART "E" – FRONT VIEW

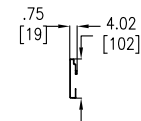

PART "E" – SIDE VIEW

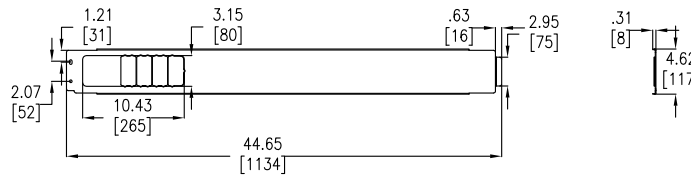

PART "F" – FRONT VIEW

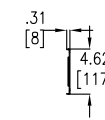

PART "F" – SIDE VIEW

NOTES:

1. INSTALLATION MUST COMPLY WITH ALL APPLICABLE NATIONAL AND LOCAL CODES.
2. PLEASE REFER TO APC PRODUCT MANUAL FOR DETAILS.
3. ALL DIMENSIONS ARE IN INCHES [MILLIMETERS].

THIS DRAWING AND SPECIFICATIONS HEREIN ARE THE PROPERTY OF SCHNEIDER ELECTRIC AND SHALL NOT BE COPIED, REPRODUCED OR USED IN WHOLE OR IN PART, AS THE BASIS FOR THE MANUFACTURE OR SALE OF ITEMS WITHOUT WRITTEN PERMISSION FROM SCHNEIDER ELECTRIC. THIS DRAWING IS BASED UPON LATEST AVAILABLE INFORMATION AND IS SUBJECT TO CHANGE WITHOUT NOTICE.



TITLE: NETSHELTER SX 42U
NEXUS 7018 DUCT KIT
PARTS A – F
MAIN MECHANICAL

PROJECT: STD SUBMITTAL DRAWINGS SHEET 3 OF 5

DWG NO: AR7742

| | | |
|---------------------------|-----------|-------|
| REV. 0 | | |
| DRAWN BY: S CUNHA | 01-AUG-11 | THIRD |
| ENGINEER: Y WANG/J KUMMER | 01-AUG-11 | ANGLE |
| APPROVED BY: T HORSTMANN | 01-AUG-11 | PROJ. |

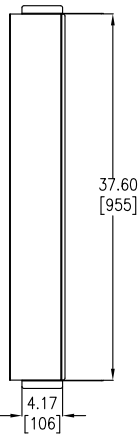

PART "G" - TOP VIEW

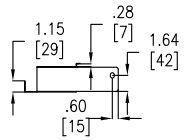

PART "G" - FRONT VIEW

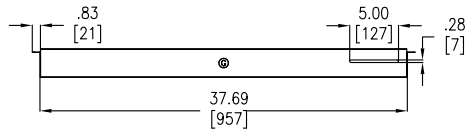

PART "G" - SIDE VIEW

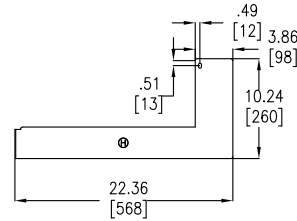

PART "H" - FRONT VIEW

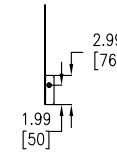

PART "H" - SIDE VIEW

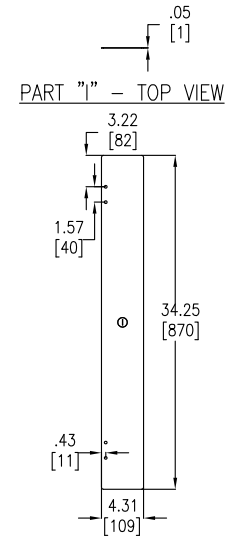

PART "I" - TOP VIEW

PART "I" - FRONT VIEW

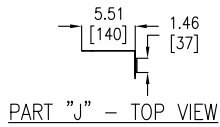

PART "J" - TOP VIEW

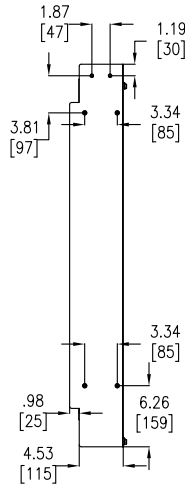

PART "J" - FRONT VIEW

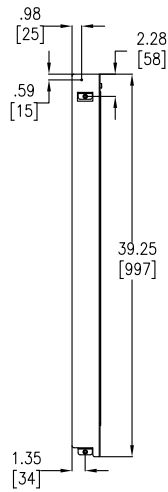

PART "J" - SIDE VIEW

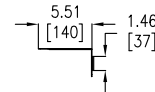

PART "K" - TOP VIEW

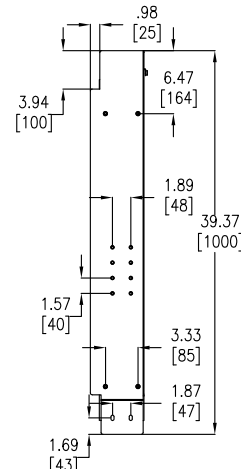

PART "K" - FRONT VIEW

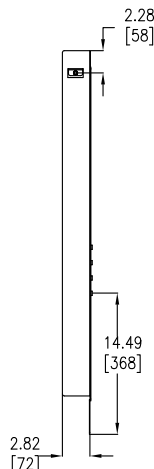

PART "K" - SIDE VIEW

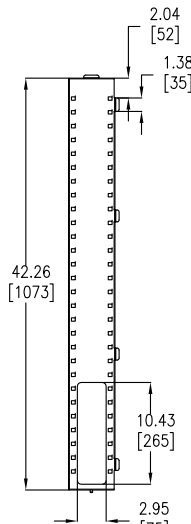

PART "L" - TOP VIEW

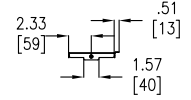

PART "L" - FRONT VIEW

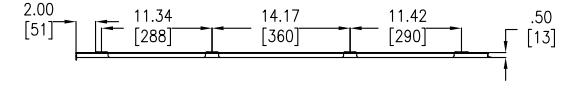

PART "L" - SIDE VIEW

NOTES:

1. INSTALLATION MUST COMPLY WITH ALL APPLICABLE NATIONAL AND LOCAL CODES.
2. PLEASE REFER TO APC PRODUCT MANUAL FOR DETAILS.
3. ALL DIMENSIONS ARE IN INCHES [MILLIMETERS].

THIS DRAWING AND SPECIFICATIONS HEREIN ARE THE PROPERTY OF SCHNEIDER ELECTRIC AND SHALL NOT BE COPIED, REPRODUCED OR USED IN WHOLE OR IN PART, AS THE BASIS FOR THE MANUFACTURE OR SALE OF ITEMS WITHOUT WRITTEN PERMISSION FROM SCHNEIDER ELECTRIC. THIS DRAWING IS BASED UPON LATEST AVAILABLE INFORMATION AND IS SUBJECT TO CHANGE WITHOUT NOTICE.



TITLE: NETSHELTER SX 42U NEXUS 7018 DUCT KIT PARTS G - L MAIN MECHANICAL

PROJECT: STD SUBMITTAL DRAWINGS SHEET 4 OF 5

DWG NO: AR7742

DRAWN BY: S CUNHA 01-AUG-11 THIRD

ENGINEER: Y WANG/J KUMMER 01-AUG-11 ANGLE

APPROVED BY: T HORSTMANN 01-AUG-11 PROJ.

REV. 0

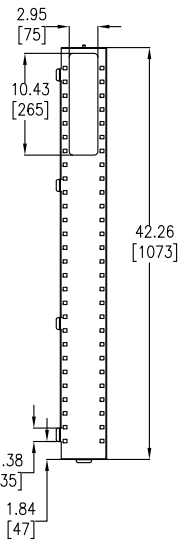

PART "M" - TOP VIEW

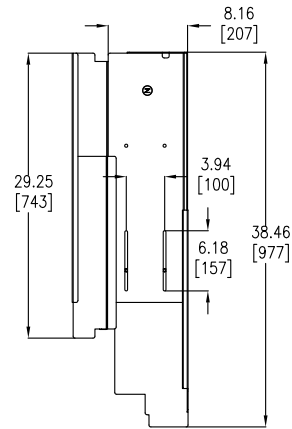

PART "N" (ASSEMBLED) - TOP VIEW

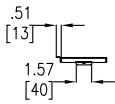

PART "M" - FRONT VIEW

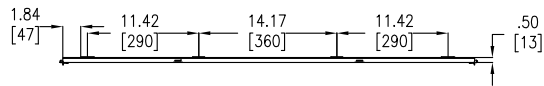

PART "M" - SIDE VIEW

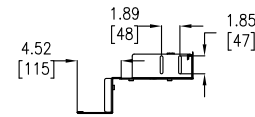

PART "N" (ASSEMBLED) - FRONT VIEW

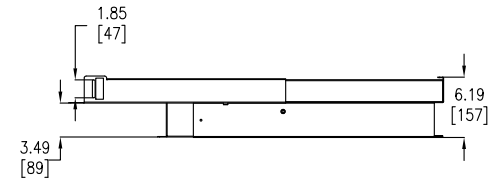

PART "N" (ASSEMBLED) - SIDE VIEW

NOTES:

1. INSTALLATION MUST COMPLY WITH ALL APPLICABLE NATIONAL AND LOCAL CODES.
2. PLEASE REFER TO APC PRODUCT MANUAL FOR DETAILS.
3. ALL DIMENSIONS ARE IN INCHES [MILLIMETERS].

THIS DRAWING AND SPECIFICATIONS HEREIN ARE THE PROPERTY OF SCHNEIDER ELECTRIC AND SHALL NOT BE COPIED, REPRODUCED OR USED IN WHOLE OR IN PART, AS THE BASIS FOR THE MANUFACTURE OR SALE OF ITEMS WITHOUT WRITTEN PERMISSION FROM SCHNEIDER ELECTRIC. THIS DRAWING IS BASED UPON LATEST AVAILABLE INFORMATION AND IS SUBJECT TO CHANGE WITHOUT NOTICE.



TITLE: NETSHELTER SX 42U
NEXUS 7018 DUCT KIT
PARTS M AND N
MAIN MECHANICAL

PROJECT: STD SUBMITTAL DRAWINGS SHEET 5 OF 5

DWG NO: AR7742

DRAWN BY: S CUNHA 01-AUG-11

ENGINEER: Y WANG/J KUMMER 01-AUG-11

APPROVED BY: T HORSTMANN 01-AUG-11

REV. 0

THIRD

ANGLE

PROJ.